



One Bedroom Apartment in Iskele

Iskele Long Beach, North Cyprus

- Property Ref: 1884
- Close to the popular Long Beach.
- Communal swimming pool.
- On-site market.
- Modern design and high quality construction.
- Payment plan options are available.

£115,000



71 m² to 89 m²



1 Bedroom



1 Bathroom



28 Months
Instalments



September 2027
Completion



One Bedroom Apartment in Iskele

Exterior Images



One Bedroom Apartment in Iskele

Interior Images



One Bedroom Apartment in Iskele

Floor Plan

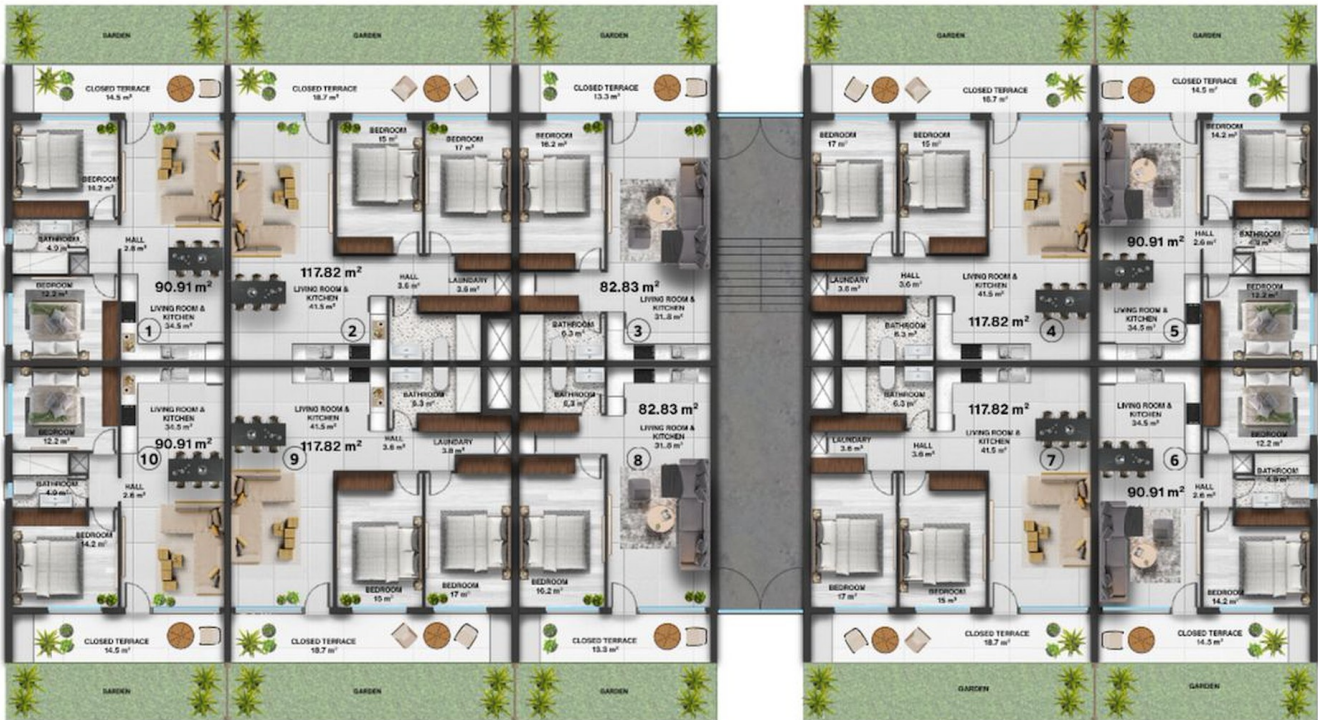

Facilities



Bar



Cafe



Children's Playground



Gardens (Landspaced)



Gated Community



Market



Parking



Pool (Outdoor)



Shops



Site Plan

Iskele Long Beach, North Cyprus



Project Location

This project is located in Long Beach, Iskele, in North Cyprus



Beach	3 mins	Bars and Clubs	5 mins
Supermarket	3 mins	Medical Center	5 mins
Pharmacy	3 mins	Salamis Ancient City	12 mins
5 Star Hotel and Casino	3 mins	Ercan International Airport	55 mins
Mackenzie Beach Club	4 mins	Larnaca International Airport	55 mins



About the Project

A thoughtfully designed residential project in İskele, North Cyprus, offering a comfortable lifestyle in a secure, well-equipped environment. Set within a gated community, this development combines modern living with natural surroundings, featuring lush green areas, walking paths, and a communal swimming pool perfect for relaxation.

Residents will enjoy on-site amenities such as a café-bar, children's playground, market, and various shops—all within walking distance of their homes. Outdoor parking is available for residents and guests.

Scheduled for completion by the end of 2027, the project offers a flexible, interest-free payment plan, making it an ideal opportunity for both investment and living.



One Bedroom Apartment in Iskele

Construction Status

April 2025



Payment Plan For This Property Type

Property Info

Type	No
1 Bedroom Apartment	13
Block	Floor
A	1
Interior	Balcony Terrace
63.71 m ²	13.03 m ²
Total Living Space	
76.74 m ²	



Payment Plan For This Property Type

Payment Plan

Current Date	Start Date	Delivery Date	Price	Initial Payment Amount
May 2025	September 2024	September 2027	£115,000	£40,250 35%

65% of the installment payment plan

1. Installment June 2025	£2,670	25. Installment June 2027	£2,670
2. Installment July 2025	£2,670	26. Installment July 2027	£2,670
3. Installment August 2025	£2,670	27. Installment August 2027	£2,670
4. Installment September 2025	£2,670	28. Installment September 2027	£2,660
5. Installment October 2025	£2,670		
6. Installment November 2025	£2,670		
7. Installment December 2025	£2,670		
8. Installment January 2026	£2,670		
9. Installment February 2026	£2,670		
10. Installment March 2026	£2,670		
11. Installment April 2026	£2,670		
12. Installment May 2026	£2,670		
13. Installment June 2026	£2,670		
14. Installment July 2026	£2,670		
15. Installment August 2026	£2,670		
16. Installment September 2026	£2,670		
17. Installment October 2026	£2,670		
18. Installment November 2026	£2,670		
19. Installment December 2026	£2,670		
20. Installment January 2027	£2,670		
21. Installment February 2027	£2,670		
22. Installment March 2027	£2,670		
23. Installment April 2027	£2,670		
24. Installment May 2027	£2,670		

