



## Two Bedroom Apartment in Yenibogazici

Yeni Bogazici, Iskele Yeni Bogazici, North Cyprus

- Property Ref: 1891
- Very spacious apartment.
- Large balcony.
- Only 1.5 km to the sandy beach.
- Affordable price.
- Flexible payment plan.

Starting from  
**£125,000**



115 m<sup>2</sup>



2 Bedrooms



1 Bathroom



8 Months  
Instalments



January 2026  
Completion



# Two Bedroom Apartment in Yenibogazici

## Exterior Images





# Two Bedroom Apartment in Yenibogazici

## Floor Plan

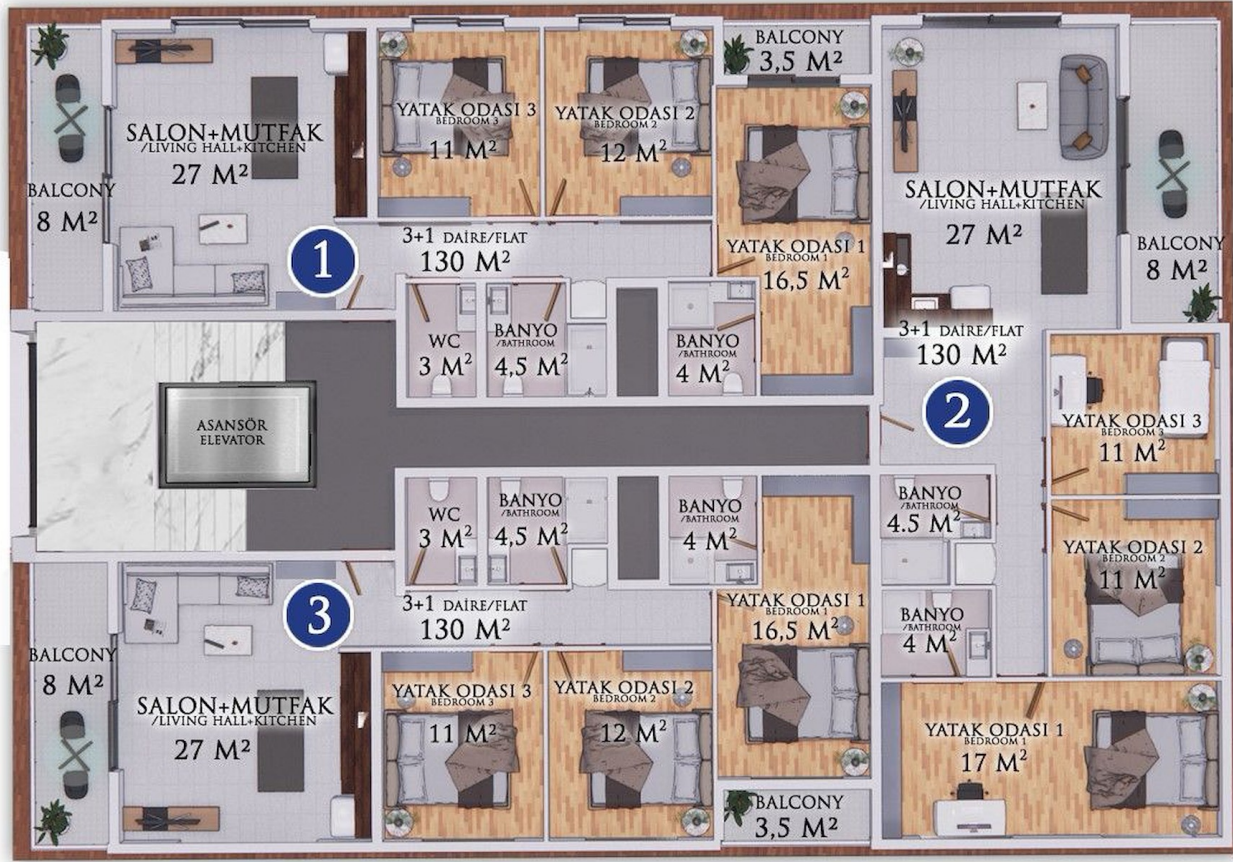

# Project Location

The project is located in the area of Yeniboazici (Famagusta), 1.5 km from the Mediterranean Sea.



Supermarket	1 min	Long Beach	5 mins
Sandy Beach	3 mins	Private School	5 mins
Hospital	3 mins	Ercan International Airport	40 mins
Salamis Ancient City	3 mins	Nicosia	45 mins
Forest	3 mins	Larnaca International Airport	55 mins



# About the Project

Modern Living and Business Opportunity in Yeniboğaziçi, North Cyprus

Located just 1.5 km from the sandy shores of Yeniboğaziçi, this brand-new three-storey development combines comfortable residential living with smart commercial investment.

The ground floor features two commercial units—ideal for shops, cafes, or offices—offering excellent visibility and accessibility.

The upper levels house spacious 3+1 and 2+1 apartments, thoughtfully designed for both modern living and high rental potential. Only one 2+1 apartment remains available—perfect for those looking to secure a prime spot in a fast-developing area.

Enjoy the benefit of a flexible, interest-free payment plan with installments available until the project's completion in January 2026.

Whether you're looking for a home, a business location, or a long-term investment, this project offers a rare opportunity in a thriving and well-connected coastal community.





# Two Bedroom Apartment in Yenibogazici

Construction Status

April 2025



# Payment Plan For This Property Type

## Property Info

Type

2 Bedroom Apartment

No

7

Floor

3

Interior

87.00 m<sup>2</sup>

Balcony Terrace

28.00 m<sup>2</sup>

Total Living Space

115.00 m<sup>2</sup>



# Payment Plan For This Property Type

## Payment Plan

Current Date	Start Date	Delivery Date	Price	Initial Payment Amount
May 2025	September 2024	January 2026	£125,000	£43,750 35%

65% of the installment payment plan

1. Installment June 2025	£10,157
2. Installment July 2025	£10,157
3. Installment August 2025	£10,157
4. Installment September 2025	£10,157
5. Installment October 2025	£10,157
6. Installment November 2025	£10,157
7. Installment December 2025	£10,157
8. Installment January 2026	£10,151

