



## Two Bedroom Apartment

Long Beach, Iskele Long Beach, North Cyprus

- Property Ref: 313
- Our project integrates modernity and comfort into every moment of your life.
- We aim to increase your living standards with our various and enjoyable activity areas.
- Facilities include gym, spa center, basketball field, swimming pool and park area.
- Close to all necessities, including supermarkets and pharmacies.
- There is the option for an extra 12 months interest free payments after receiving the keys to your property!

Starting from  
**£235,000**



77 m<sup>2</sup> to 130 m<sup>2</sup>



2 Bedrooms



2 Bathrooms



25 Months  
Instalments



June 2027  
Completion





# Two Bedroom Apartment

## Exterior Images





# Two Bedroom Apartment

## Interior Images

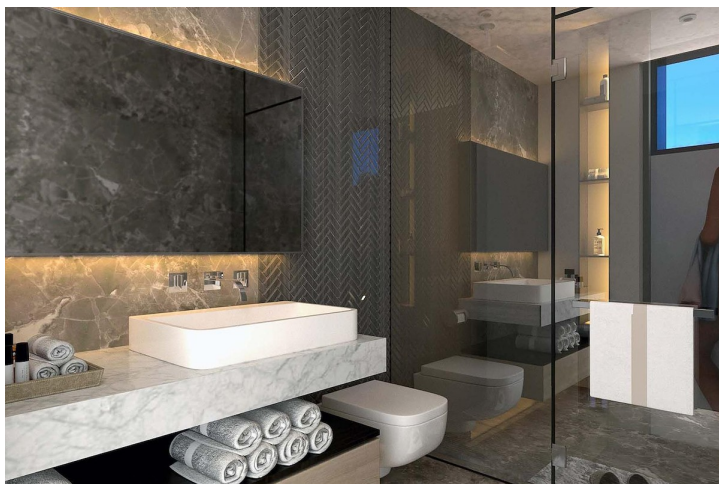

# Two Bedroom Apartment

## Floor Plan

### Type 1 (2+1)

H-I-J-K Block  
Ground Floor

1. L. Room + Kitchen	: 28m <sup>2</sup>
2. Master Bedroom	: 16m <sup>2</sup>
3. Master Bathroom	: 5m <sup>2</sup>
4. Bedroom	: 13m <sup>2</sup>
5. Bathroom	: 6m <sup>2</sup>
6. Balcony	: 4m <sup>2</sup>
7. Common Area	: 9m <sup>2</sup>

Gross Usage Area	: 81m <sup>2</sup>
Garden Usage Area	: 21m <sup>2</sup>
Total Usage Area	: 102m <sup>2</sup>

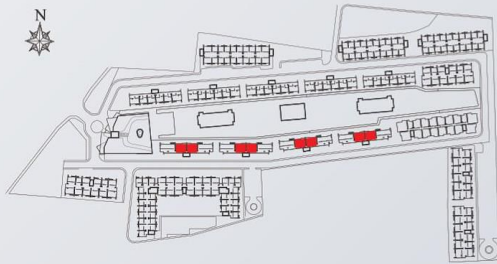



# Facilities



Bar



Cafe



Central Generator  
System (Communal  
Areas)



Fitness



Gardens (Landspaced)



Gated Community



Parking



Pool (Outdoor)



Restaurant



Running Paths



Shuttle Service



Spa



Tennis





# Site Plan

Long Beach, Iskele Long Beach, North Cyprus





# Project Location

Dolce Vita, located in **İskele Long Beach**, is surrounded by the beach and forest.



Supermarket	5 mins	Private Hospital	11 mins
Cafes and Restaurants	5 mins	Cemal Baleses Stadium	12 mins
Pharmacy	7 mins	Ercan Airport	45 mins
Salamis Ancient City	7 mins	Larnaca Airport	68 mins
Beach	8 mins		





# About the Project

This project, which opens all the doors of luxury life to the end, is waiting for you to realise your dreams with its privileges that will enrich your life! Located in the centre of the magnificent nature of Iskele, Dolce Vita offers various opportunities to its visitors and investors with different residences and commercial area options.

They offer an unutterable life space with the unique air and sea of Iskele Long Beach, the rising value of Northern Cyprus, the pearl of the Mediterranean. Iskele Long Beach, which is easily accessible from all over the island, is located in a magnificent location and at the same time attracts attention with its settlement away from the noise of the city.

Our project, which is planned to improve your quality of life, integrates modernity and comfort into every moment of your life with hot tub, security camera, central generator, automatic entrance gate, private garden, terrace, car park, central hydrophore system, satellite, central purification system, air conditioning system, site security.



# Two Bedroom Apartment

Construction Status

April 2025



March 2025



# Payment Plan For This Property Type

## Property Info

Type	No
2 Bedroom Apartment	9
Block	Floor
S	0
Interior	Balcony Terrace
73.00 m <sup>2</sup>	4.00 m <sup>2</sup>
Total Living Space	Plot
77.00 m <sup>2</sup>	18.00 m <sup>2</sup>





# Payment Plan For This Property Type

## Payment Plan

Current Date	Start Date	Delivery Date	Price	Initial Payment Amount
May 2025	June 2024	June 2027	£235,000	£82,250 <span>35%</span>

40% of the installment payment plan

1. Installment June 2025	£3,760	25. Installment June 2027	£3,760
2. Installment July 2025	£3,760		
3. Installment August 2025	£3,760		
4. Installment September 2025	£3,760		
5. Installment October 2025	£3,760		
6. Installment November 2025	£3,760		
7. Installment December 2025	£3,760		
8. Installment January 2026	£3,760		
9. Installment February 2026	£3,760		
10. Installment March 2026	£3,760		
11. Installment April 2026	£3,760		
12. Installment May 2026	£3,760		
13. Installment June 2026	£3,760		
14. Installment July 2026	£3,760		
15. Installment August 2026	£3,760		
16. Installment September 2026	£3,760		
17. Installment October 2026	£3,760		
18. Installment November 2026	£3,760		
19. Installment December 2026	£3,760		
20. Installment January 2027	£3,760		
21. Installment February 2027	£3,760		
22. Installment March 2027	£3,760		
23. Installment April 2027	£3,760		
24. Installment May 2027	£3,760		



# Payment Plan For This Property Type

## Payment Plan

**25%** Payment plan remaining after delivery

1. Installment July 2027	£2,448
2. Installment August 2027	£2,448
3. Installment September 2027	£2,448
4. Installment October 2027	£2,448
5. Installment November 2027	£2,448
6. Installment December 2027	£2,448
7. Installment January 2028	£2,448
8. Installment February 2028	£2,448
9. Installment March 2028	£2,448
10. Installment April 2028	£2,448
11. Installment May 2028	£2,448
12. Installment June 2028	£2,448
13. Installment July 2028	£2,448
14. Installment August 2028	£2,448
15. Installment September 2028	£2,448
16. Installment October 2028	£2,448
17. Installment November 2028	£2,448
18. Installment December 2028	£2,448
19. Installment January 2029	£2,448
20. Installment February 2029	£2,448
21. Installment March 2029	£2,448
22. Installment April 2029	£2,448
23. Installment May 2029	£2,448
24. Installment June 2029	£2,446

