



Two Bedroom Semidetached Villa Near The Beach in Tatlisu

Tatlisu, Kyrenia East, North Cyprus

- Property Ref: 356
- The beach 3 min by walk.
- Detached private garden.
- Top roof terrace.
- Sea and mountain view.
- Ensuit in every bedroom.

£310,000



191 m² to 221 m²



2 Bedrooms



3 Bathrooms



9 Months Instalments



April 2026
Completion



Two Bedroom Semidetached Villa Near The Beach in Tatlisu

Exterior Images



Two Bedroom Semidetached Villa Near The Beach in Tatlisu

Interior Images



Two Bedroom Semidetached Villa Near The Beach in Tatlisu

Floor Plan

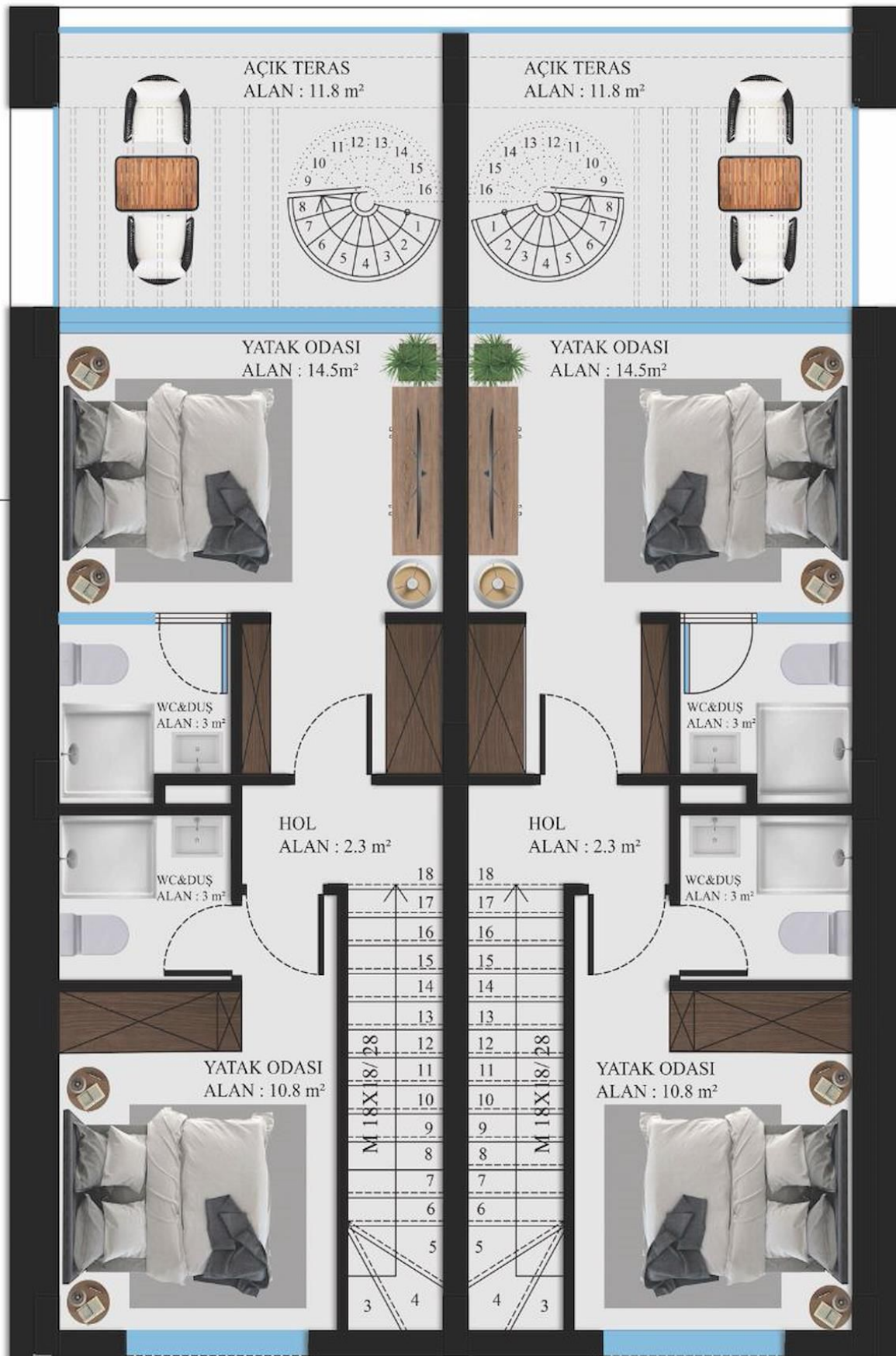

Facilities



Bar



Cafe



Children's Playground



Gardens (Landspaced)



Gated Community



Mini Golf Course



Onsite Management



Parking



Pool (Outdoor)



Restaurant



Sauna



Spa



Site Plan

Tatlisu, Kyrenia East, North Cyprus



Project Location

This beautiful complex is located a 3-minute walk from the beach in the quiet Tatlisu area.



| | | | |
|------------------------|---------|-----------------|---------|
| Market | 1 min | Golf Club | 18 mins |
| Beach by walking | 3 mins | Ercan Airport | 40 mins |
| Tatlisu | 3 mins | Famagusta | 40 mins |
| Zambak Holiday Village | 9 mins | Kyrenia | 45 mins |
| Esentepe Beach | 14 mins | Larnaca Airport | 65 mins |



About the Project

This beautiful complex is located a 3-minute walk from the beach in the quiet Tatlisu area.



Two Bedroom Semidetached Villa Near The Beach in Tatlisu

Construction Status

June 2025



May 2025



Payment Plan For This Property Type

Property Info

| | |
|-------------------------------|-----------------------|
| Type | No |
| 2 Bedroom Semi-detached Villa | 1 |
| Block | Floor |
| C | 0 |
| Interior | Balcony Terrace |
| 105.00 m ² | 41.00 m ² |
| Rooftop | Total Living Space |
| 45.00 m ² | 191.00 m ² |



Payment Plan For This Property Type

Payment Plan

| | | | | |
|--------------|------------|---------------|----------|------------------------|
| Current Date | Start Date | Delivery Date | Price | Initial Payment Amount |
| June 2025 | April 2024 | April 2026 | £310,000 | £155,000 50% |

50% of the installment payment plan

| | |
|-------------------------------|---------|
| 1. Installment July 2025 | £17,223 |
| 2. Installment August 2025 | £17,223 |
| 3. Installment September 2025 | £17,223 |
| 4. Installment October 2025 | £17,223 |
| 5. Installment November 2025 | £17,223 |
| 6. Installment December 2025 | £17,223 |
| 7. Installment January 2026 | £17,223 |
| 8. Installment February 2026 | £17,223 |
| 9. Installment March 2026 | £17,216 |

