



One Bedroom Penthouse in Esentepe

Esentepe, Kyrenia East, North Cyprus

- Property Ref: 671
- Located just 60 m from the sea.
- Will be constructed in accordance with earthquake regulation.
- Indoor facilities (pool, gym, spa, turkish bath, steam room).
- Outdoor facilities (infinity pool, ornamental pool, BBQ area, botanical garden, children playground).
- Generator.

Starting from
£258,500



139 m²



1 Bedroom



1 Bathroom



18 Months
Instalments



April 2025
Completion

Email: sales@dmgpropertygroup.com
Website: www.northcyprusprojects.com



Kibris Sunum

One Bedroom Penthouse in Esentepe

Exterior Images



One Bedroom Penthouse in Esentepe

Interior Images



One Bedroom Penthouse in Esentepe

Floor Plan



A BLOK BİRİNCİ KAT PLANI

Facilities



Central Generator
System (Communal
Areas)



Children's Playground



Fitness



Gardens (Landspaced)



Parking



Pool (Heated Indoor)



Pool (Outdoor)



Sauna



Spa



Steam Room



Turkish Hammam



Site Plan

Esentepe, Kyrenia East, North Cyprus

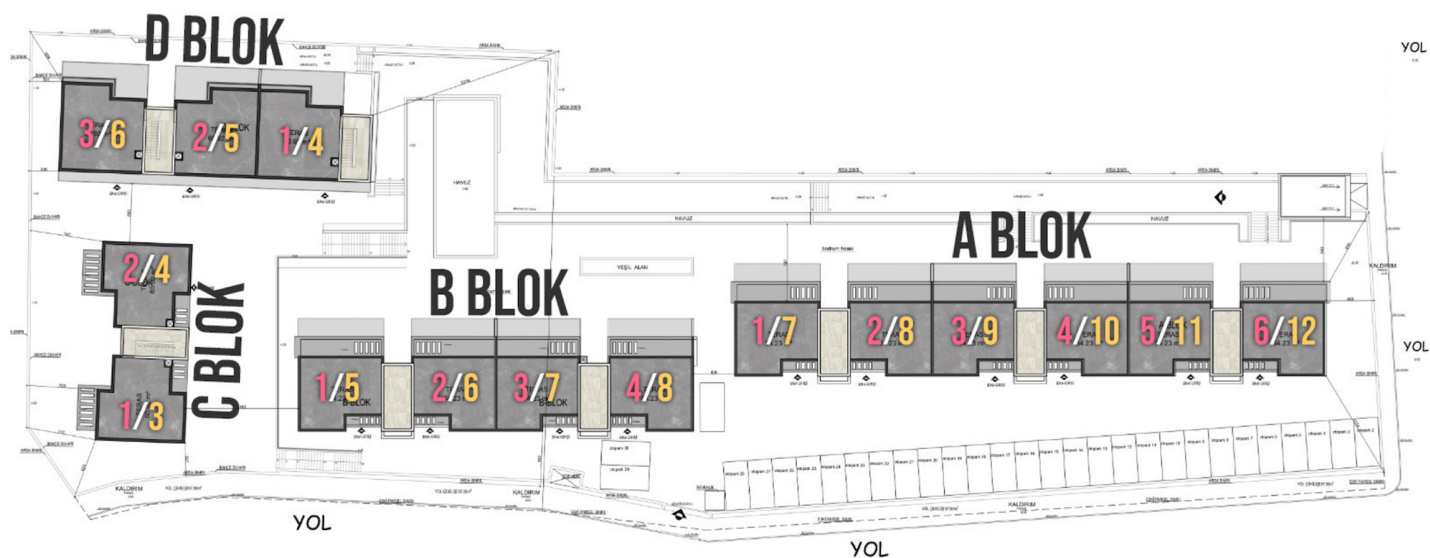

Project Location

The complex is located in the Esentepe area on the north coast.



Sea	1 min	Korineum Golf Club	9 mins
Supermarket	2 mins	Kyrenia	25 mins
Beach Club	2 mins	Famagusta	28 mins
Restaurants and Bars	2 mins	Ercan Airport	45 mins
Pharmacy	5 mins	Larnaca Airport	65 mins



About the Project

Welcome to your dream beachside retreat! This magnificent house, located just a stone's throw away from the captivating sea, offers the epitome of luxurious coastal living.

Built with utmost care and in accordance with strict earthquake regulations, this property provides not only a stylish and contemporary design but also peace of mind for you and your loved ones. With safety at its core, this house promises a lifetime of tranquility amidst breathtaking surroundings.

Step inside to discover an array of indoor facilities that will make everyday living feel like a blissful getaway. Dive into crystal clear waters within the comfort of your private pool or break a sweat in the state-of-the-art gym before unwinding in the soothing spa. Every aspect has been meticulously designed to create an environment perfect for relaxation and well-being.



One Bedroom Penthouse in Esentepe

Construction Status

April 2025



March 2025



Payment Plan For This Property Type

Property Info

Type	No
1 Bedroom Penthouse	12
Block	Floor
A	1
Interior	Total Living Space
139.00 m ²	139.00 m ²



Payment Plan For This Property Type

Payment Plan

Current Date	Start Date	Delivery Date	Price	Initial Payment Amount
May 2025	December 2022	April 2025	£258,500	£129,250 50%

50% Payment plan remaining after delivery

1. Installment June 2025	£7,181
2. Installment July 2025	£7,181
3. Installment August 2025	£7,181
4. Installment September 2025	£7,181
5. Installment October 2025	£7,181
6. Installment November 2025	£7,181
7. Installment December 2025	£7,181
8. Installment January 2026	£7,181
9. Installment February 2026	£7,181
10. Installment March 2026	£7,181
11. Installment April 2026	£7,181
12. Installment May 2026	£7,181
13. Installment June 2026	£7,181
14. Installment July 2026	£7,181
15. Installment August 2026	£7,181
16. Installment September 2026	£7,181
17. Installment October 2026	£7,181
18. Installment November 2026	£7,173

